

LightCraft 17.4m Fireboat

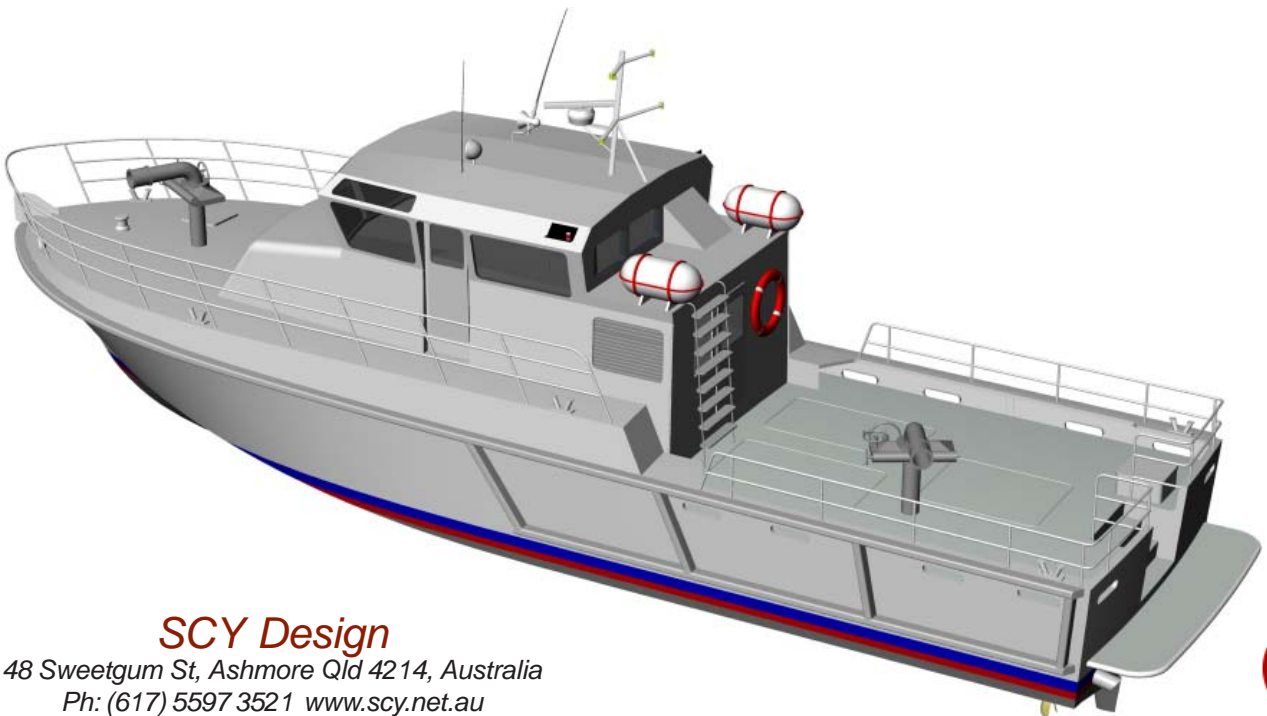

SCY Design

48 Sweetgum St, Ashmore Qld 4214, Australia
Ph: (617) 5597 3521 www.scy.net.au



LightCraft

17.4m Fireboat



SCY Design

48 Sweetgum St, Ashmore Qld 4214, Australia

Ph: (617) 5597 3521 www.scy.net.au

LightCraft

17.4m Fireboat

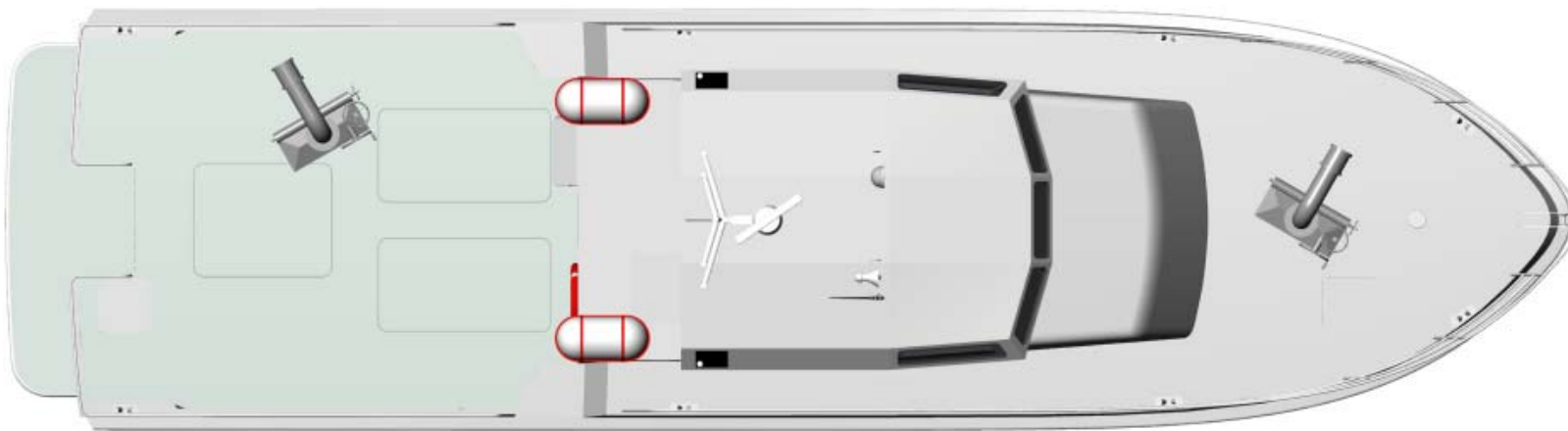

LOA :	18.4m
Lmoulded:	17.4m
LWL :	16.0m
Beam :	4.6m
Draft :	1.30m
Fuel :	3000lts
Power :	2 x 433kW
Speed :	20 knots

Classification :
DNV R3 PATROL
NSCV 2C

Construction :
Marine Grade Aluminium



SCY Design

48 Sweetgum St, Ashmore Qld 4214, Australia
Ph: (617) 5597 3521 www.scy.net.au

17.4m Fire Boat

PRINCIPAL PARTICULARS

LOA: 18.4m
 Lmoulded: 17.4m
 LWL: 16.0m
 BEAM: 4.6m
 DRAFT: 1.30m
 AIR DRAFT: 5.0m
 SPEED: 18knots
 MAIN ENGINE: 2 x CUMMINS QSM11
 449kW @ 2300rpm
 GEARBOX: 2 x ZF325-1A
 PROPULSION: 2 x FIXED PITCH PROPS
 GENSET: 2 x ONAN MDKBS 22.5kW
 FUEL: 3000lts
 FRESH WATER: 400lts
 SULLAGE: 300lts
 DECK GARGO: 8 tonnes
 AFT DECK AREA: 27m²
 CREW: 4

FIREFIGHTING EQUIPMENT

PUMP ENGINE: 2 x CUMMINS 4BT3.9-M
 112kW @ 2800rpm
 FIRE PUMPS 2 x 215m³/hr 10bar
 FWD FIRE MONITORS: 2 x Remote 200m³/hr 9bar
 FWD FIRE MONITORS: 2 x Manual 200m³/hr 9bar
 FOAM: 2800lts

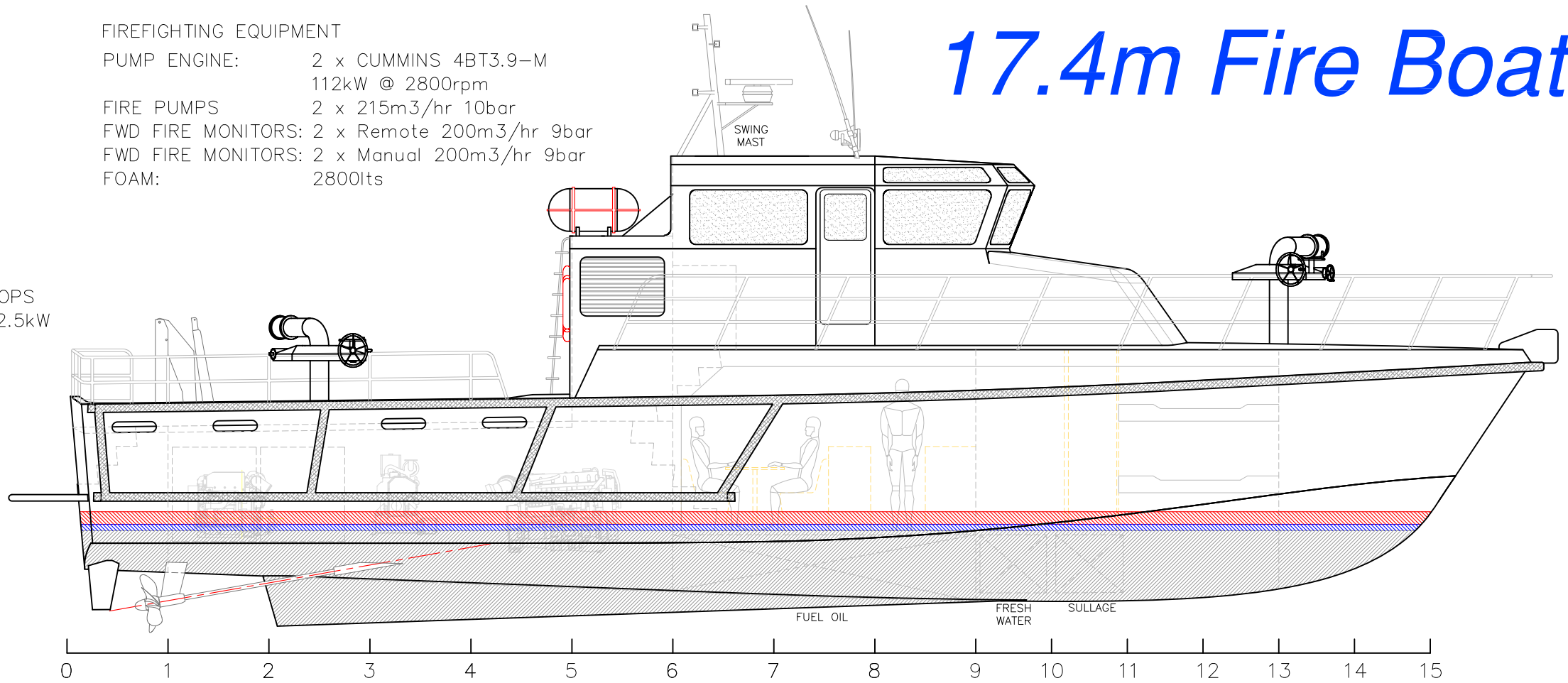

SURVEY: NSCV 2C

STRUCTURE:
 GERMANISCHER LLOYDS

*100 A5 OC2 HSDE Patrol Boat

CONSTRUCTION:
 MARINE GRADE ALUMINIUM

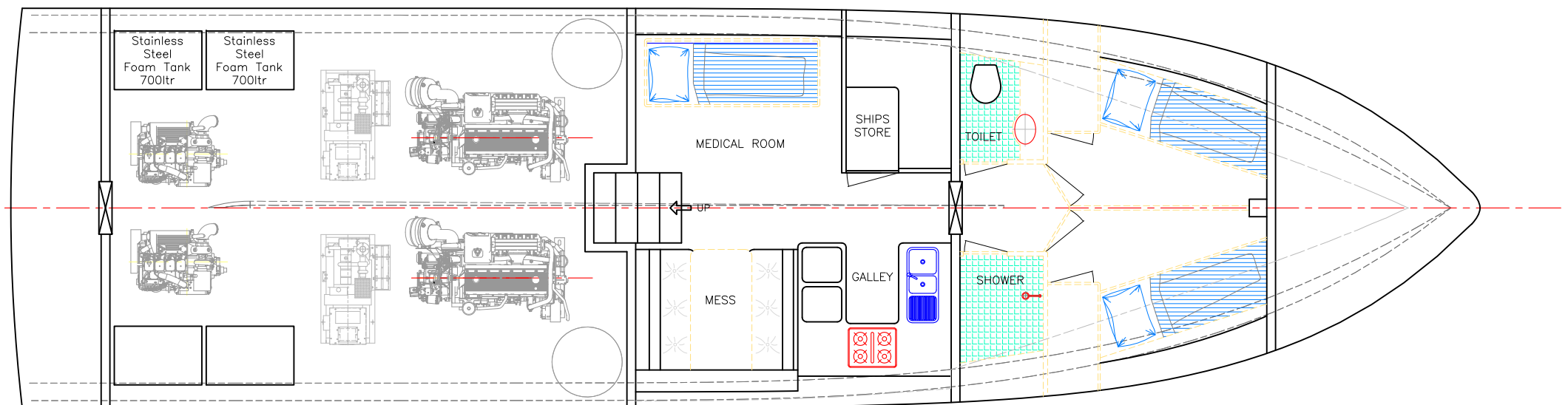
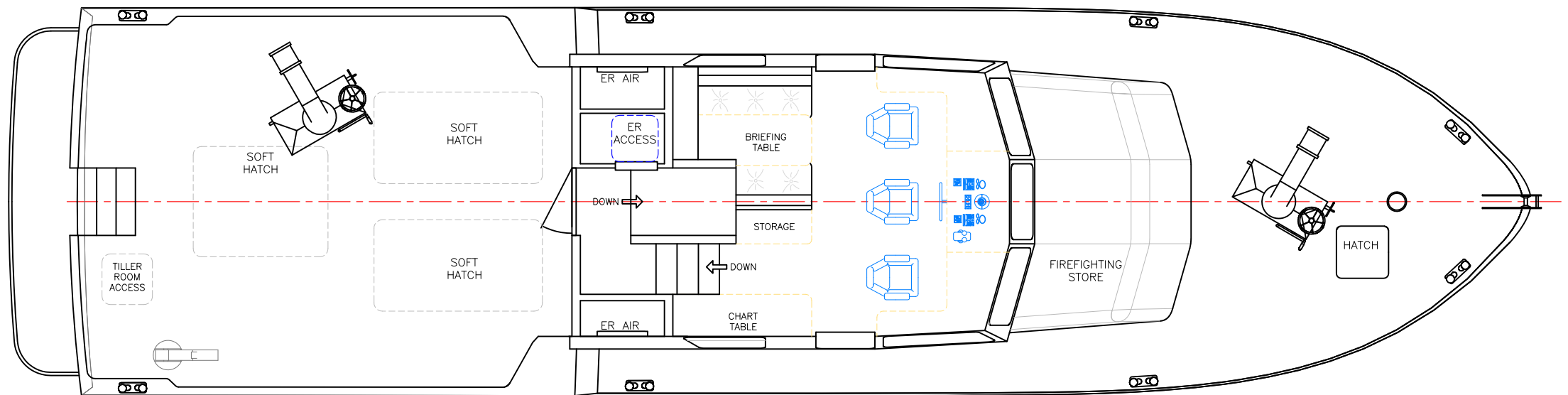

VESSEL: 17.4m Fireboat
 TITLE: GENERAL ARRANGEMENT
 DWG No: 17FB-100
 DATE: 15/5/2006
 SCALE:
 DRAWN: MDW

SCY Design
 Consulting Naval Architects & Mechanical Engineers
 48 Sweetgum St, Ashmore, Queensland 4214, Australia
 Ph: 617 5597 3521 www.scy.net.au

COPYRIGHT © THIS DRAWING AND THE INFORMATION CONTAINED HEREON IS SUPPLIED ON THE UNDERSTANDING THAT IT IS THE EXCLUSIVE PROPERTY OF SOUTHPORT CUSTOM YACHTS PTY. LTD. AND MUST NOT BE USED OR REPRODUCED IN WHOLE OR IN PART WITHOUT PERMISSION IN WRITING.