

LightCraft

16m Fast Patrol Craft



SCY Design

48 Sweetgum St, Ashmore Qld 4214, Australia

Ph: (617) 5597 3521 www.scy.net.au



LightCraft

16m Fast Patrol Craft



SCY Design

48 Sweetgum St, Ashmore Qld 4214, Australia

Ph: (617) 5597 3521 www.scy.net.au

LightCraft

16m Fast Patrol Craft



LOA :	17.5m
Lmoulded:	16.1m
LWL :	14.9m
Beam :	4.60m
Draft :	0.80m
Fuel :	4000lts
Power :	2 x 882kW
Speed :	42 knots

Classification :
DNV ✕1A1 HSLC R3 PATROL

Construction :
Marine Grade Aluminium



SCY Design
48 Sweetgum St, Ashmore Qld 4214, Australia
Ph: (617) 5597 3521 www.scy.net.au

16m Fast Patrol Craft

Vessel Description

VESSEL TYPE: Planing Monohull

SURVEY AND CLASSIFICATION:

DNV ✕1A1 HSLC R3 Patrol , shall comply with the requirements of Queensland Survey NSCV 2B

STRUCTURE:

Materials (to be inspected as required by Survey Authority and Owners Representative):

Sheet and Plate - Grade 5083-H321, H116, 5086-H32. Extrusions - Grade 6061-T6, 6082-T5

OUTFIT AND FINISHING:

The vessel shall be laid out as per the general arrangement drawings and all fittings and equipment required for the operation of the vessel shall be supplied.

Layout: Main Deck: Operations Room

Lower Deck: Galley / Mess Area, Twin Berth Officers Cabin, Toilet, Shower, 4 berth crew cabin, Ships Store

Aft Deck: 22sqm work deck, Toilet/Shower. Optional 4.0 metre RIB stowed in aft deck recess, deployed and retrieved via hinged ramp on transom.

Fitout: Floors: "Aquadeck"

Lining's: External Decks : Non-skid paint

Sides Aluminium honeycomb panels (Ayrlite)

Bulkheads Aluminium honeycomb panels (Ayrlite)

Noise Levels

The noise level at the centre of each crew and passenger area shall not exceed 75 dB(A) and the noise level at the centre of the wheelhouse shall not exceed 65 dB(A).

AIR CONDITIONING SYSTEM:

Reverse cycle system is based on an water cooled compressor unit linked up to a multiple number of fan coil units. Design of the system shall be based upon an ambient operating temperature of 40°C (95% RH) and sea water of 320°C. Crew spaces to be cooled/heated to 21°C (50% RH).

NAVIGATION and COMMUNICATION EQUIPMENT:

Furuno Model 1510 15" Radar with 6ft antenna 15mtr cable ARP17 Plotter GCY8 Gyro converter

JMC 1400 Dual frequency sounder 50/200 1kw

JMC NP-30NT with GPS ANTENNA

ICOM-IC-M700 complete with tuner and Banten HF antenna

Icom IC-M502 VHF Radio with Banten antenna

Sailor C2906 Inmarsat C VMS unit

KVH Trac phone Inmarsat M

Navicontrol Autopilot 3003 Gold with second station

Cetrek "Poseidon" compass

Den Haan DHR CS-220 Searchlight

Closed circuit TV monitoring of engine room and main deck. All navigation equipment interfaced to Flying Bridge displays.

SCY Design

48 Sweetgum St, Ashmore Qld 4214, Australia

Ph: (617) 5597 3521 www.scy.net.au



PRINCIPAL PARTICULARS

LOA: 17.5m
 Lmoulded: 16.1m
 LWL: 14.9m
 BEAM: 4.6m
 DRAFT: 0.8m
 SPEED: 42knots
 MAIN ENGINE: 2 x MAN D2868 L433
 882kW @ 2300rpm
 GEARBOX: ZF2000
 PROPULSION: HJ403
 FUEL: 4000lts
 WATER: 1000lts
 AFT DECK: 26.1m2

CLASS STANDARD:
 DNV R3 PATROL
 SURVEY: NSCV 2B

CONSTRUCTION:
 MARINE GRADE ALUMINIUM

16m FAST PATROL

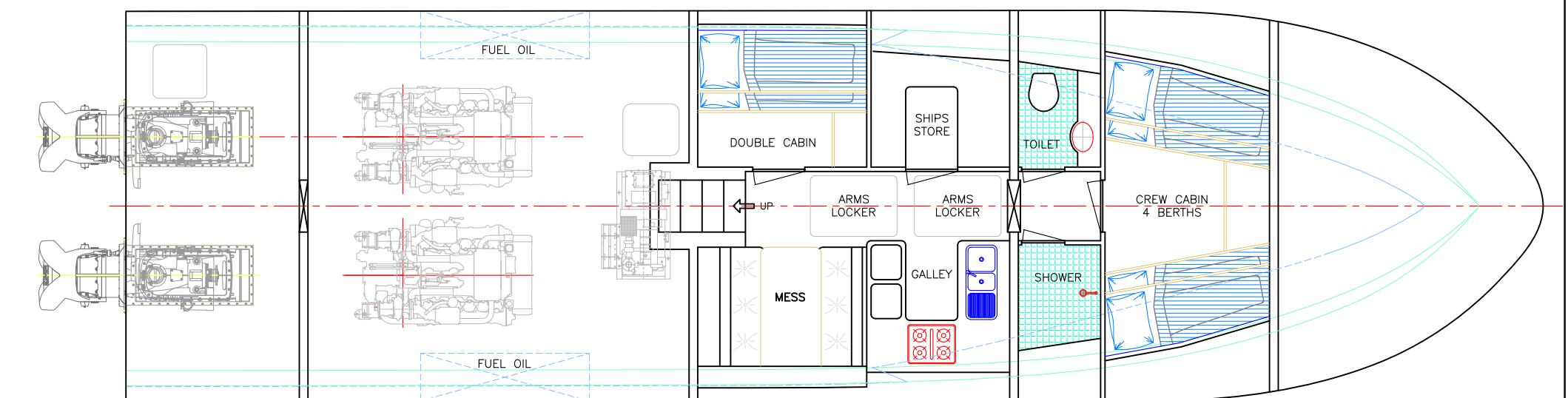
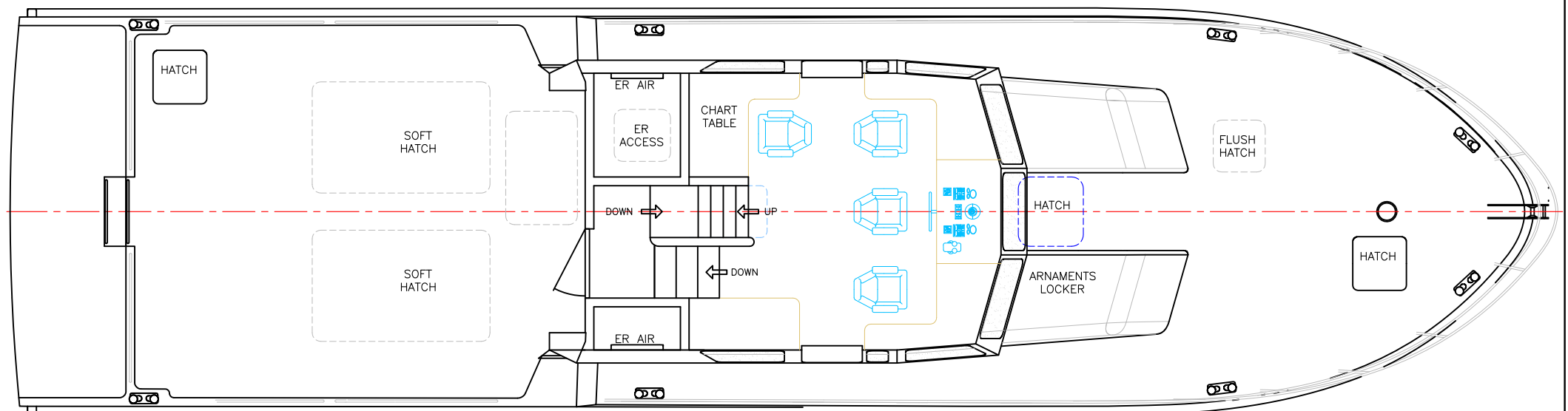
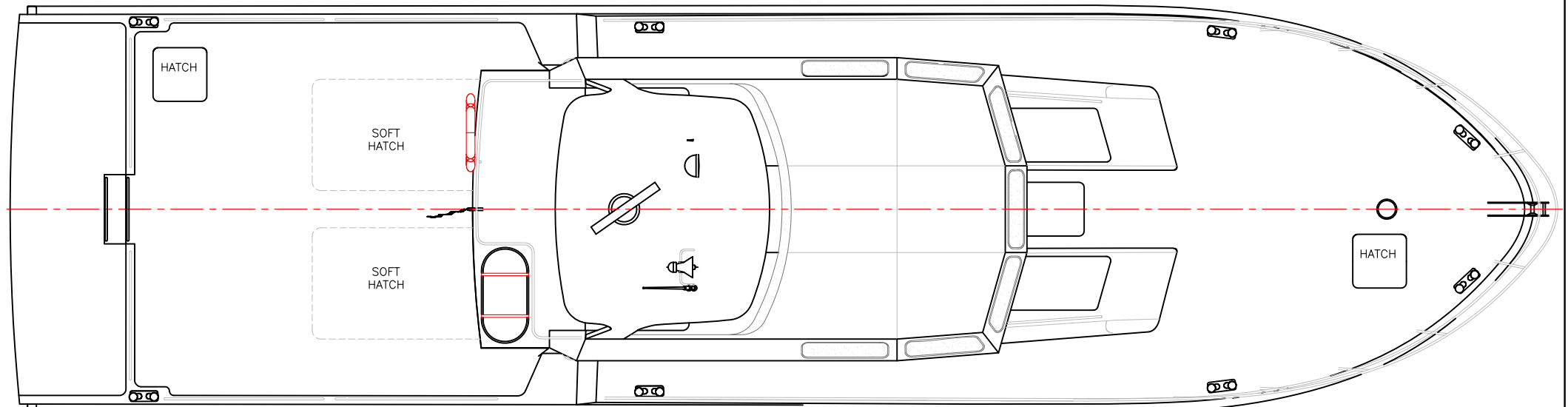
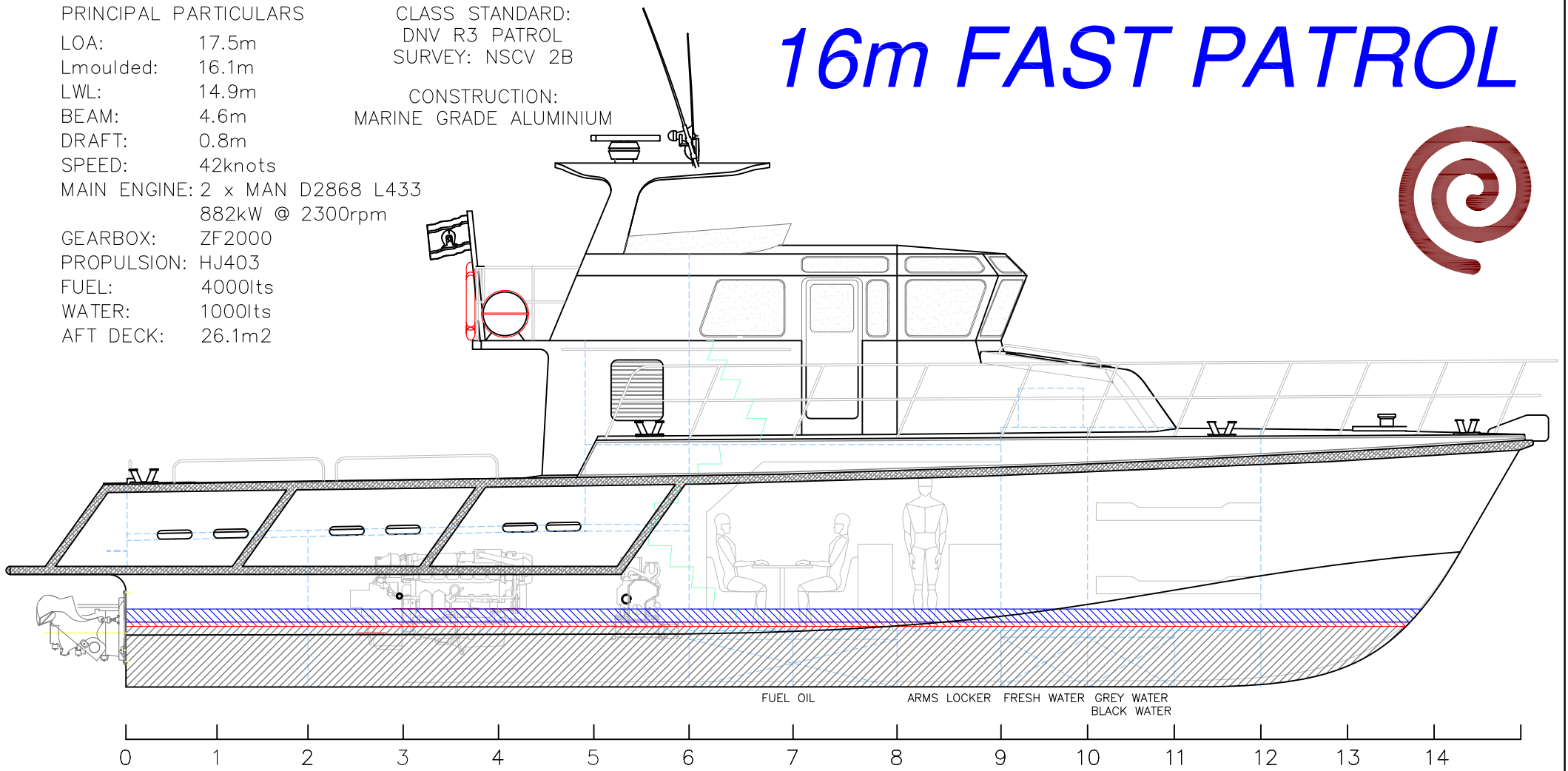

LightCraft
 aluminium patrol boats

VESSEL:	16m Fast Patrol Boat
TITLE:	GENERAL ARRANGEMENT
DWG No:	16FP-100
DATE:	7/3/2013
SCALE:	
DRAWN:	MDW

SCY Design
 Consulting Naval Architects & Mechanical Engineers
 48 Sweetgum St, Ashmore, Queensland 4214, Australia
 Ph: 617 5597 3521 www.scy.net.au

copyright © THIS DRAWING AND THE INFORMATION CONTAINED HEREON IS SUPPLIED ON THE UNDERSTANDING THAT IT IS THE EXCLUSIVE PROPERTY OF SOUTHPORT CUSTOM YACHTS PTY. LTD. AND MUST NOT BE USED OR REPRODUCED IN WHOLE OR IN PART WITHOUT PERMISSION IN WRITING.

scy16m Fast Patrol Weight Summary

LC 1 - Trials Condition

Lightship				22095	6.45	1.98
fuel - main	50%	4000	0.84	1680	7.70	0.60
water	50%	1000	1.00	500	10.60	0.55
sullage	10%	200	1.00	20	11.60	0.55
crew/effects		4	80	320	8.20	4.00
stores				200	8.15	1.50
deck gear				250	2.00	0.85
addn crew		2	80	160	7.80	1.80
deadweight				3130	7.82	1.08
departure condition				25225	6.62	1.87

speed estimate 42knots

range 390nm @ 25knots

LC 2 - Operational Fully Loaded Condition

Lightship				22095	6.45	1.98
fuel - main	100%	4000	0.84	3360	7.70	0.40
water	100%	1000	1.00	1000	10.60	0.40
sullage	0%	200	1.00	0	11.60	0.40
crew/effects		4	80	320	8.20	4.00
stores				200	8.15	1.50
deck gear				250	2.00	0.85
addn crew		2	80	160	7.80	1.80
deadweight				5290	8.03	0.72
departure condition				27385	6.76	1.74

speed estimate 40.5knots

LC 3 - Maximum Load Condition

Lightship				22095	6.45	1.98
fuel - main	100%	4000	0.84	3360	7.70	0.40
water	100%	1000	1.00	1000	10.60	0.40
sullage	0%	200	1.00	0	11.60	0.40
crew/effects		4	80	320	8.20	4.00
stores				200	8.15	1.50
deck gear				600	2.00	0.85
addn crew		12	80	960	7.80	1.80
deadweight				6440	7.67	0.86
departure condition				28535	6.73	1.73

16m FAST PATROL

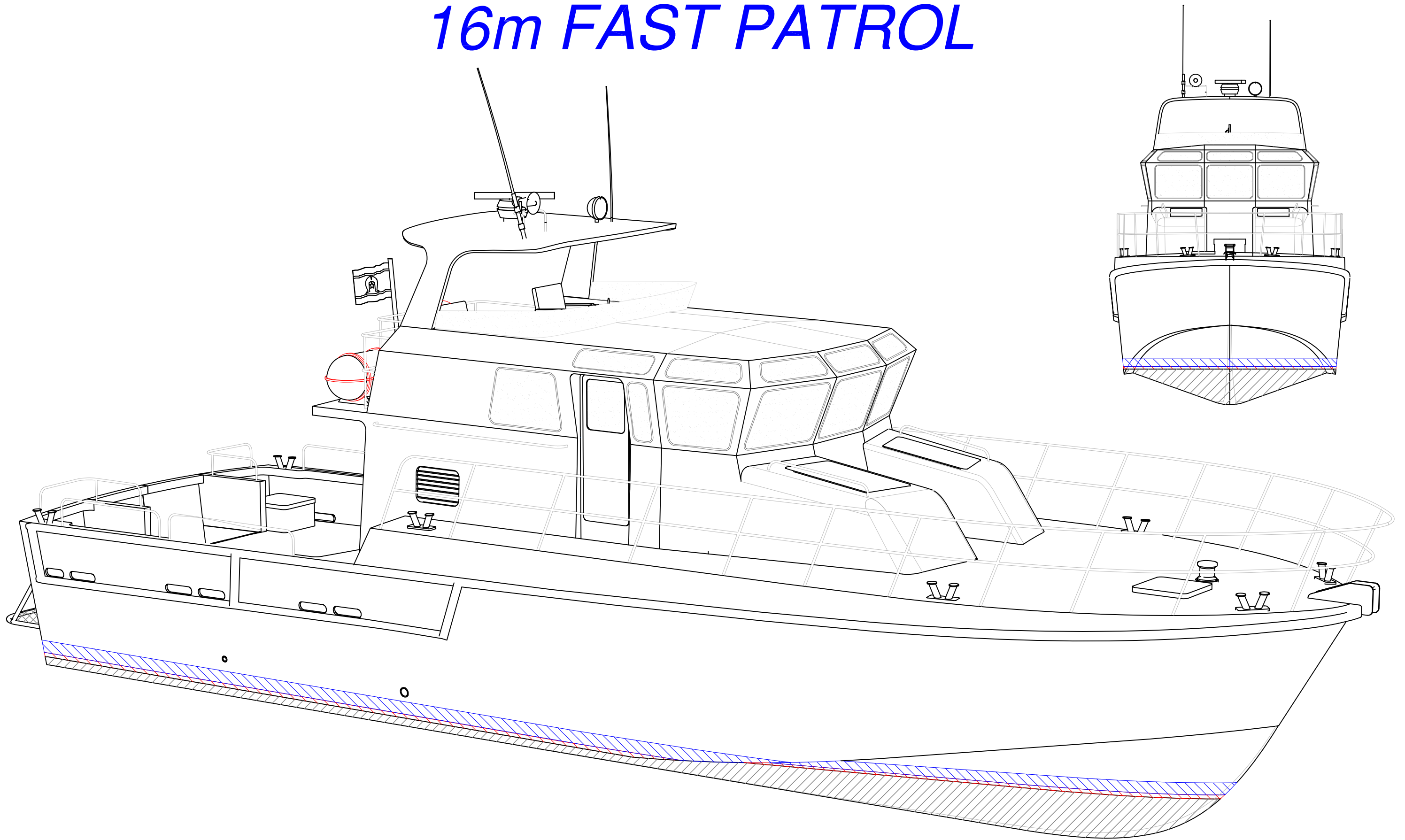

SCY Design

Consulting Naval Architects & Mechanical Engineers

48 Sweetgum St, Ashmore, Queensland 4214, Australia

Ph: 617 5597 3521 www.scy.net.au